

Bimetal Thermometer Type 18

Stainless steel – Domestic and Heating



Temperature Element:	Coiled Bimetal
Accuracy:	Class 1 per DIN 16203
Case material:	Stainless steel
Pointer:	Black aluminium
Window:	Instrument glass
Location of stem:	Centre back
Stem material:	Stainless steel
Connection:	Thermowell G ½ , Stainless steel
Pressure rating of thermowell:	6 bar maximum
Optional extras:	Thread other than G ½, Other connections, Thermowell stainless steel 1.4571

Thermometer Typ	Case (mm)	Code	Location of stem	Code	Scale range °C	Code	Stem (mm)	Code	Connection	Code
18	63	3	horizontal	1	0 bis 100	100	45	045	Thermowell	
	80	6			0 bis 160	160	50	050	G 1/2	24
	100	7			0 bis 200	200	60	060	G 3/4	25
	160	8			0 bis 250	250	63	063	Solid connection	
					0 bis 300	300	100	100	G 1/2	44
					0 bis 400	400			G 3/4	45
					0 bis 500	500			Union nut	
									G 1/2	64
									G 3/4	65

Dimensions: Standard version

With thermowell

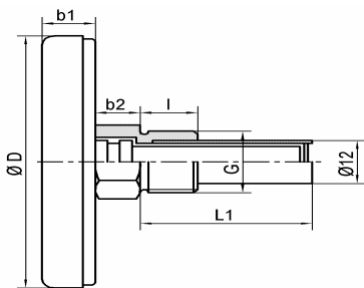

with solid connection

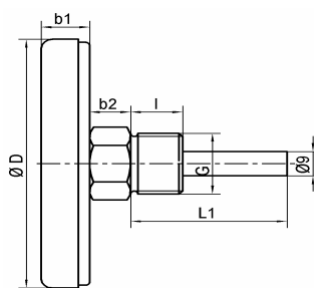

With union nut

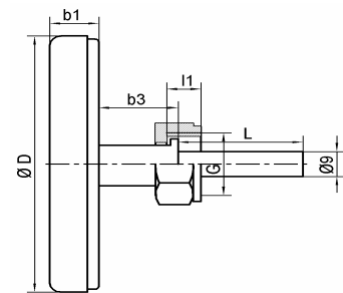

Ø D (mm)	G (Zoll)	l (mm)	l1 (mm)	b1 (mm)	b2 (mm)	b3 (mm)	SW (mm)	SW (Union nut)
63	G 1/2	14	10	10	10	18	21	24
	G 3/4	16	12	10	12	18	24	32
80	G 1/2	14	10	11	10	18	21	24
	G 3/4	16	12	11	12	18	24	32
100	G 1/2	14	10	11	10	18	21	24
	G 3/4	16	12	11	12	18	24	32
160	G 1/2	14	10	12	10	18	21	24
	G 3/4	16	12	12	12	18	24	32